

*Thompson, Spoor & Thompsons Addition
To the City of Ann Arbor*

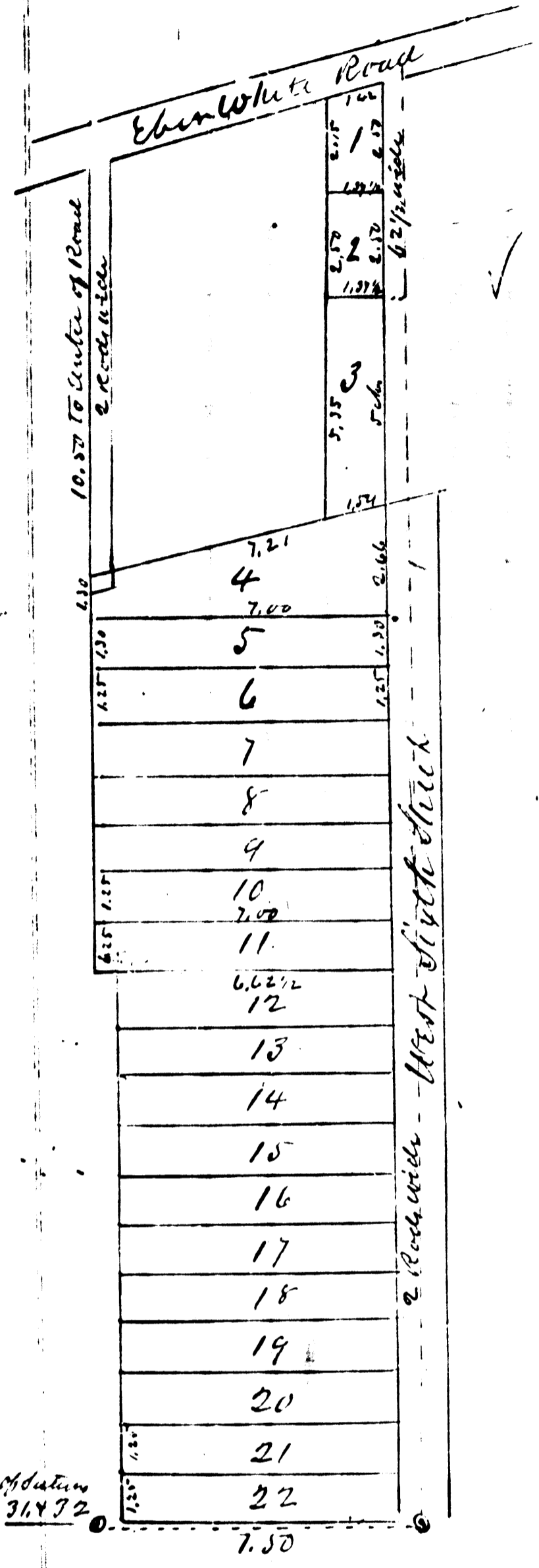

Registered Office Washburn Co. p. Rec'd & Recorded this 11th day of April, A.D. 1861. at 2 1/2 o'clock P.M. in Liber No. 48 of Deeds page 83 - J. R. McLean, Regr. J. M. Ladd, Dep.

This addition to the City of Ann Arbor is situated on the west part of the west half of the south west quarter of Section twenty nine, of Township Two South of Range Six East, extending from the Eberwhite Road, to within 17 links of the line between sections 29 and 32. The length of lines being the length and width of lots are given in Reap chains and links in small figures. The numbers of the lots are given in large figures near the center of the lots thus 1, 2, 3.

That part of the street on the East side appropriated by the proprietor is 112 1/2 links wide from the Eberwhite Road to the South East corner of Lot No. 2. The west bounds then runs to the north East corner of Lot No. 4, when it is 50 links or 2 rods wide then continuing the same width to the South East of the plat

Scale 4 ch. or 16 rods to the inch.

I hereby certify that I am a Surveyor by profession and practice, and that I made the survey of the above plat of Spoor & Thompsons Addition the 4th day of May A.D. 1860. S. Pittabone, Surveyor County of Washburn, State of Michigan. On this 5th day of May A.D. 1860 at Ann Arbor in said County personally appeared before me a Notary Public in and for said County, Samuel Pittabone, known to me to be the person who signed the within certificate, acknowledged and declared that he is a Surveyor by profession and that he made the survey of the land represented on the within plat, or map at the request of Spoor & Thompson the proprietors and that he signed the above certificate, and that the above map is a true representation of the same. J. M. Williamson, Notary Public

We Charles Spoor, Charles B. Thompson, and John W. Thompson the proprietors of the land upon which the within plat is located do hereby adopt and make the same our Plat, and dedicate the streets and highways marked thereon to the Public, in pursuance of the Statute in such case made and provided, and we do hereby require the Register of Deeds for the County of Washburn, in the State aforesaid to record said Plat. And we Mary Spoor wife of Charles Spoor, Appalonia M. wife of Charles B. Thompson and Florida A. wife of John W. Thompson, do hereby assent to the said plat and remit and release all our right to Down of us, and to the streets, highways, or public grounds laid down and dedicated therein. In Witness whereof, we the said Charles Spoor and his wife Mary, Charles B. Thompson and his wife Appalonia M. John W. Thompson

Ann Arbor
4, 30, 31, 32