

MAP
 of
 A. TENBROOK'S
 ADDITION
 to the
 CITY
 of
 ANN ARBOR

Scale, 2 chains = 1 in
 Measurements
 are in chains.

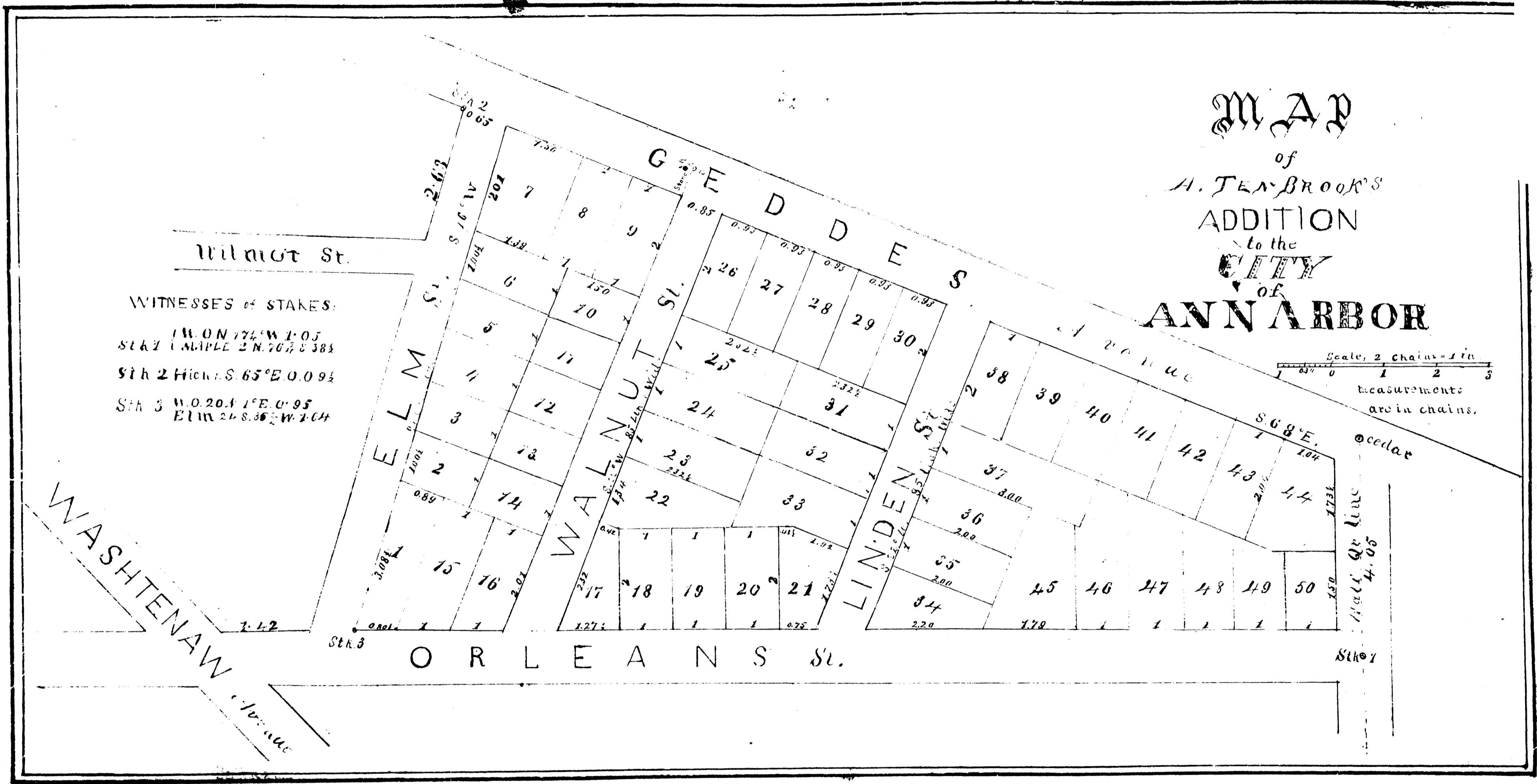

WITNESSES of STAKES:
 Sta 1 W. ON 174° W 1.05
 Sta 2 N. MAPLE 2 N. 70 1/2 S 383
 Sta 2 High. S. 65° E. 0.09 1/2
 Sta 3 W. O. 20.4 1° E. 0.95
 Elm 24 S. 36 1/2 W. 2.04

Original map of Ann Arbor, Michigan, showing the location of the City of Ann Arbor, Michigan, and the location of the City of Ann Arbor, Michigan, and the location of the City of Ann Arbor, Michigan.

Registers Office Washtenaw County
 issued for record to 15th day of April A. D. 1873 and recorded in Liber 73 of Books
 on page 190. at 10th o'clock A.M. E. G. ...