

## City of Ann Arbor Green Infrastructure

# Miller Avenue—Newport to Maple Stormwater Improvements

- **Completed:** 2013
- **Design Cost:** \$480,000
- **Construction Cost:** \$5,377,000 (est.)
- **Stormwater Utility Fund Portion:** \$1,290,000 (est.)
- **Other GI Funding Sources:** State Revolving Fund – Low Interest Loan and 50% Loan Forgiveness on stormwater portion
- **Partners:** Washtenaw County Water Resources Commissioner, City of Ann Arbor Parks and Recreation

### Green Infrastructure:

- Multiple rain gardens in lawn extension
- Two large rain gardens in public parks
- Impervious surface reduction
- Oversized pipes

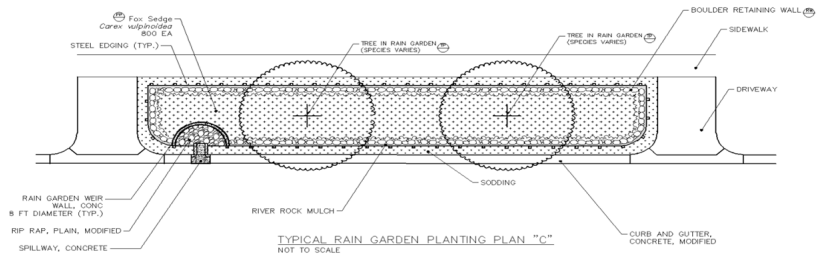
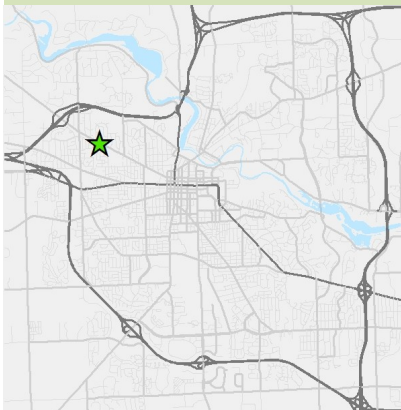

Stormwater improvements for the Miller Avenue drainage sub basins, located in the Allen’s Creek and Honey Creek watersheds, included underground pipe storage with downstream weir controlled outlet structures, above ground bioretention areas and rain gardens. These systems are designed to work together to provide downstream water quality & design event storm water runoff peak flow attenuation.

The water treatment systems and bioretention areas will slow storm water from Miller Avenue and thus lengthen the time for discharge of design event storms from Miller Avenue to the downstream stormwater conveyance systems. In addition, the bioretention areas and rain gardens filter, purify and store rain water, supports plant life, and create an aquatic habitat.

The project also involved complete reconstruction of the roadway, improved bicycle lanes, pedestrian crossings with



raised islands, and intermittent left turn lanes, sections of new sidewalks, new sidewalk ramps, concrete bus stop pads, and sidewalk repairs, utility work that replaces a distribution water main within the project limits and a portion of sanitary sewer.

